



Thermakraft® Thermaflash®

Adhesion Synthetic Window Flashing Tape



- Self-adhering window flashing tape for window and door joinery openings
- Provides bonding to most building surfaces and wall underlays
- Can be installed in a wide range of temperatures
- Suitable for timber and steel framed buildings
- Compatible with Kingspan Thermakraft building membranes
- AS 4200.1:2017 compliant

Product Data

Product Description

Kingspan Thermakraft Thermaflash is a self-adhering window flashing tape. The adhesive provides bonding to most building surfaces and wall membranes. It is suitable for window and door installation as well as other wall penetrations. Kingspan Thermakraft Thermaflash can be installed in a wide range of temperatures and can withstand UV exposure for up to 180 days.

Thermaflash comes in two roll sizes:

Product Code	Roll size	Rolls per carton
THFLASH075023	75mm x 23m	16
THFLASH150023	150mm x 23m	8

Scope of Use

Kingspan Thermakraft Thermaflash window flashing tape can be used as a flexible flashing system around window and door joinery openings on timber and steel framed buildings within the following scope:

- Installed into and around joinery openings over the wall wrap and exposed frame to cover both the face and edge of the opening as a secondary weather resistant barrier.
- Installed at joinery heads to seal flashing upstands to the wall wrap.
- To assist the overall weathertightness performance of window and door joinery installations.
- To be used in conjunction with air seals and joinery flashing systems. Installer must check for air seal product compatibility with Kingspan Thermakraft Thermaflash.

General

- Synthetic backing and adhesive.
- Kingspan Thermakraft Thermaflash can be used with either a taped corner or Kingspan Thermakraft Corner Moulds (optional).
- Kingspan Thermakraft Thermaflash is compatible with Kingspan Thermakraft building membranes.
- Unaffected by LOSP or other solvent based treated timber. However, LOSP or other solvent based treated timber must have sufficient time for the solvent chemical to flash off in a well ventilated area. Recommended minimum 7 days.

Limitations

- Must not be exposed to the weather/UV for more than 180 days.
- Kingspan Thermakraft Thermaflash should be installed when temperatures are above -10°C.
- Kingspan Thermakraft Thermaflash is not designed to overcome poor detailing and workmanship of the window or door joinery installation.
- Most window sealants will bond directly to Kingspan Thermakraft Thermaflash. However, Installer must check the bonding strength and chemical compatibility of the sealant and tape before installation.
- When Kingspan Thermakraft Thermaflash is used with rigid air barrier or rigid wall sheathing products, follow the flashing tape installation instructions set out by the rigid air barrier or rigid wall sheathing product supplier. Building designer/specifier/installer must check with the rigid air barrier or rigid wall sheathing product supplier to ensure that Kingspan Thermakraft Thermaflash window flashing tape is fully compatible and is warranted with their product system.
- When using Kingspan Thermakraft Thermaflash on medium or high rise buildings, building designer/specifier needs to incorporate Kingspan Thermakraft Thermaflash as part of the external wall cladding system design along with the rigid air barrier or rigid wall sheathing product specified.

Compliance

Kingspan Thermakraft Thermaflash complies with the AAMA 711-13 standard: Voluntary Specification for Self-Adhering Flashing Used for Installation of Exterior Wall Fenestration Products and it is tested by BRANZ in accordance with the ICBO Evaluation Service Inc. Acceptance Criteria for Flashing Materials (AC148, 2001).

Durability

When Kingspan Thermakraft Thermaflash is used and installed in accordance with Kingspan Insulation literature:

- Kingspan Thermakraft Thermaflash is expected to have a serviceable life equal to that of the cladding*, provided Kingspan Thermakraft Thermaflash is not exposed to the weather or ultra-violet (UV) light for more than 180 days, or damaged upon installation.

* Note: When the external cladding is maintained according to the cladding manufacturer's instructions and the cladding remains weather resistant, Kingspan Thermakraft Thermaflash window flashing tape is expected to have a serviceable life equal to that of the cladding.

- Kingspan Thermakraft Thermaflash is designed to work on building membranes that meet the requirements of AS 4200.1:2017 Pliable building membranes and underlays.

Installation Instructions

Application Method

- Cut the wall underlay/air barrier at a 45° angle away from each corner. Fold flaps tightly into the window or door opening and fix with staples on the back faces of the framing.
- Fix an orange corner mould to the bottom corners by way of staples or clouts to the two jambs. Always ensure that Kingspan Thermakraft Thermaflash is applied to surfaces that are clean and free of dust, contaminants, solvents, oils or waxes. Note the following: 150mm wide tape is used for 100mm wide window or door framing, and 200mm wide tape is used for 140mm to 150mm wide reveals. (With steel framing, use double sided tape to attach the corner mould).
- Corner mould is optional. However, lower butterfly strips must be installed in the absence of the corner mould. The lower butterfly strips must be installed first at 45° across the window sill corners before applying the window sill tape piece. The butterfly strip needs to overlap the window sill corners by 3mm to create a seal at the corner junction. The size of the butterfly strip is 75mm wide x 100mm long.
- Add 400mm to the length of the window sill and cut to suit that measurement to allow a 200mm upstand at either side of the window opening.
- First remove the release film from the tape; align the back edge of the tape with the inside edge of the sill.
- Firmly press the tape onto the wall underlay to ensure good adhesion and ensure the tape is fitted tightly into the jamb to window sill corners.
- At the sill/jamb corners cut the tape from the external edge of the frame outwards. Fold flaps back onto the wall underlay/air barrier and press tape firmly for good adhesion.
- A second layer of 75mm wide Kingspan Thermakraft Thermaflash flashing tape must then be installed along the entire length of the windowsill. The tape is installed flush with the exterior face of the opening. This is a mandatory requirement for horizontal surfaces to ensure nail penetrations self-seal.
- Proceed to fit the window flashing tape to the top corners of the frame (200mm across lintel x 200mm down jamb).
- For window or door lintel to jamb junction, apply a butterfly using the 75mm wide x 100mm long Thermaflash. Fix at a 45° angle to the jamb with an overlap at the corner of 3mm.
- Door frames are to be treated similarly to window openings. The sill may be either a timber or a concrete floor.
- Kingspan Thermakraft Thermaflash is used to seal the upstand of the window head flashing to the building underlay. (Refer to the cladding/window manufacturer's details).
- Kingspan Thermakraft Thermaflash must not be left exposed to the weather/UV for more than 180 days.

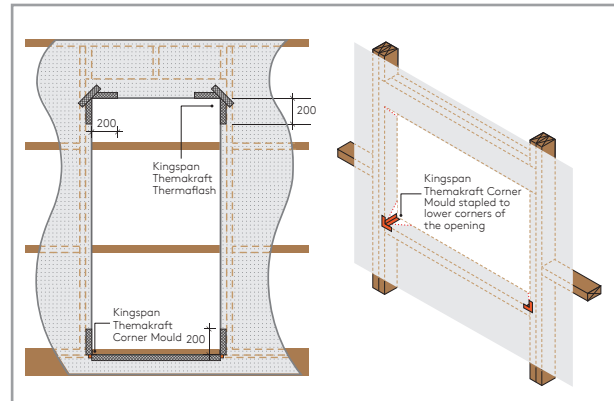

Figure 1. Kingspan Thermakraft Thermaflash installation.

Application Tips

- Apply firm pressure onto the tape during installation. This will ensure proper adhesion of the tape to the building underlay or other substrates.
- Install Kingspan Thermakraft Thermaflash above -10°C.
- Unaffected by LOSP or other solvent based treated timber. However, LOSP or other solvent based treated timber must have sufficient time for the solvent chemical to flash off in a well ventilated area. Recommended minimum 7 days.

Important Information

To assist the adhesion of Kingspan Thermakraft Thermaflash flashing tape on difficult to bond surfaces, Kingspan suggests the following:

Difficult to Bond Substrates Surface Preparation:

- Always ensure that Kingspan Thermakraft Thermaflash is applied to surfaces that are clean and free of dust, contaminants, solvents, oils or waxes.
- **Application of Scotch Super 77 Spray Adhesive:** When installing Kingspan Thermakraft Thermaflash flashing tape on difficult to bond substrates, Scotch Super 77 Spray Adhesive may be used. Ensure that the substrate is dry and free of dirt before applying the spray adhesive. Apply a light spray/coating of the spray adhesive onto the substrate. Wait for a minute to allow the spray adhesive to become tacky. When tacky to the touch apply the flashing tape in the normal manner.

Adhesives and Sealants:

- Most window sealants will bond directly to Kingspan Thermakraft Thermaflash. However, Installer must check the bonding strength of the sealant before installation.
- The installer must check the compatibility of the Kingspan Thermakraft Thermaflash flashing tape with the sealant or adhesive product to ensure the components are fully compatible.

Other Information

Handling and Storage

Kingspan Thermakraft Covertex 407 must be handled with care to prevent damage such as tearing and roll deformation.

The product must be stored under cover well away from direct moisture, rainfall contact and sunlight (UV). Care should be taken not to stack other materials on top of the product.

Product Warranty

Standard Kingspan Insulation Warranty applies. Refer to Kingspan Insulation Warranty Statement for further details. This is available online at thermakraft.com.au or call 1300 247 235.

Contact Details

Austech

Austech Building Products Pty Ltd

M: 0403 055 024

E: gus@austech.com.au

www.austech.com.au



© Kingspan, Thermakraft, Covertex and the Lion Device are Registered Trademarks of the Kingspan Group plc in Australia and other countries. All rights reserved. © Kingspan Insulation Pty Ltd.

Kingspan Insulation Pty Ltd reserves the right to amend product specifications without prior notice. The information, technical details and fixing instructions etc. included in this literature are given in good faith and apply to uses described. Recommendations for use should be verified as to the suitability and compliance with actual requirements, specifications and any applicable laws and regulations. For other applications or conditions of use, Kingspan Insulation offers a Technical Advisory Service the advice of which should be sought for uses of Kingspan Insulation products that are not specifically described herein. Please check that your copy of the literature is current by contacting us or visiting www.thermakraft.com.au/products/roof-underlay/covertex-407

